

RIVERSIDE SOUTH

PHASE 15-3-1 SINGLES



EFFECTIVE: October 19, 2021

PRINTED: June 15, 2026

613 425 0377

riverside@richcraft.com

Lot premiums apply on certain lots.

Subject to change without notice E.&O.E

Model restrictions apply. See sales rep for details.

LOT SIZES

- E - 31'
- A - 35'
- B - 44'
- C - 50'



RIVERSIDE SOUTH

PHASE 17 SINGLES

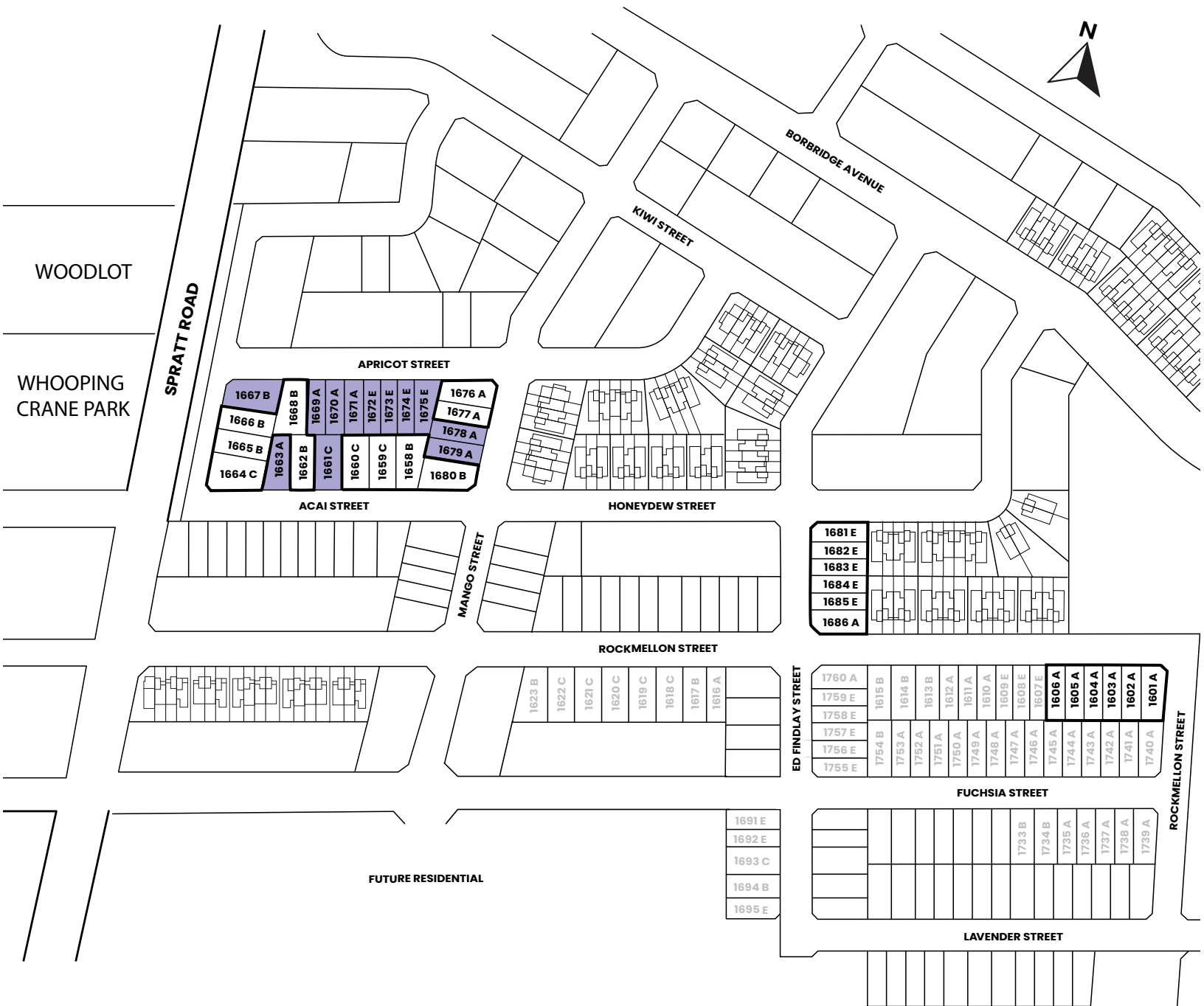

EFFECTIVE: July 25, 2024

PRINTED: June 26, 2026

613 425 0377

riverside@richcraft.com

Lot premiums apply on certain lots.

Subject to change without notice E.&O.E

Model restrictions apply. See sales rep for details.

LOT SIZES	
E	- 31'
A	- 35'
B	- 44'
C	- 50'

 **SOLD**

 **RELEASED**

RICHCRAFT